



HSW Systems
Single Track Sliding Glass Walls

NanaWall®

Boundaries **Unbound.™**

Boundaries

Unbound.™



We make walls that **open up new possibilities.**

NanaWall doesn't think your vision should be limited by the constraints of standard fenestration. Which is why our products offer capabilities beyond the conventional. Our HSW systems' single track sliding glass walls present innovative solutions to your design problems, through an incomparable blend of ingenuity, functionality, agility and beauty that sets your imagination free.



HSW Systems Single Track Sliding Glass Walls.

HIGHLIGHTS

Our HSW systems' single track sliding glass walls offer you transformative design flexibility. With limitless spans of top-hung individual panels that ride within a single narrow head track over a single floor track—or over no floor track at all—our HSW systems help you make bolder creative statements, while producing multiple experiences in a single space.

- Extremely large openings are possible with unlimited spans of individual panels.
- Virtually any shape is possible, including open corners.
- Systems offer customizable stacking bay options for panels.
- HSW60 System allows swing doors to be placed anywhere in the panel span.
- Single floor track (or no floor track) offers cleaner lines and smoother transitions.
- End-to-end closure for secure, rattle-free and draft-free weather protection.



Tiburon Hills Residence, Tiburon CA

HSW60, panels and swing door stack away from opening, weather resistant low profile no channel saddle sill, open corner configuration
Architect: David Kotzebue Architecture

Our HSW systems let you make the most of your space—and your **creative possibilities.**



The new shape of flexibility.

A clean sweep of panels negotiate angle changes up to 90°—navigating around multiple corners and through segmented curves, while bypassing columns and other structural obstacles.

- Virtually any shape is possible. Walls may be designed as open corner, T-intersection or segmented.
- Tracks may be laid to the inside or outside of structural supports or columns, allowing panels to maneuver around obstacles.
- When unlocked, unattached panels move easily and independently, enabling partial openings.

Unlimited widths. Larger panels. Broader horizons.

The number of panels possible in our HSW systems is limited only by imagination and structural constraints, producing spans for the widest of openings. Individual panel dimensions can reach a maximum of 4 feet (1220 mm) wide and 12 feet (3660 mm) tall.

Remote stacking optimizes valuable space.

Customizable stacking bay options allow opened panels to be parked remotely and/or hidden in closets—often creating unobstructed pure openings. Learn more about this feature in our “Stacking Concepts” section on pages 18 and 19.

A. United Nations International School, New York NY
 HSW60, panels stack away from opening, segmented curve, no floor track configuration
 Architect: Skidmore, Owings & Merrill

B. Snap-On Tools, Kenosha WI
 HSW60, panels stack away from opening, 12' panels with sound insulated glazing, no floor track configuration
 Architect: Butterfield, Rudie & Seitz Architects

C. Confidential Banking Establishment
 HSW60, panels and swing door stack away from opening, swing door with commercial kick plate, flush sill configuration



Swing entry doors that slide away.

Our HSW60 System allows swing doors to be placed almost anywhere within the panel span, facilitating traffic flow. These commercial-grade doors may be easily converted to sliding panels that store with other panels away from openings. If desired, a pair of swing panels may be used to form a conventional entrance.

- Can accommodate self-closers, panic hardware and push/pull handles.
- Tested to 500,000 opening and closing cycles per AAMA 920 test standard.



One head track. One floor track. (And sometimes, no floor track.)

Our lack of multiple floor tracks eliminates both the “train station” effect and the need to design extra-wide headers. Our HSW systems can also eliminate floor tracks altogether in favor of adjustable, embedded floor sockets, creating an undivided floor expanse.

- Interlocking panels stay in one plane, creating a smooth, streamlined look.
- Trackless option is ideal for interior applications, or—in milder, temperate climates—exterior spaces with large overhangs.



Weather protection, performance and testing.

The design of our HSW systems, supported by superior materials and strenuous testing, yields rugged, energy-efficient walls that perform dependably through weather extremes, temperature fluctuations and repeated use.

- Walls have endured the latest AAMA testing standards for air, water, structural loads and forced entry.
- All products are NFRC-rated and certified for true energy efficiency in all climates.



American-designed solutions, engineered in Germany.

Our HSW systems are engineered in Germany, providing world-class quality and long-term reliability.

- NanaWall is a single-source turnkey manufacturer.
- We operate a state-of-the-art production facility for our folding systems in Richmond, California.

D. American AgCredit Headquarters, Santa Rosa CA
HSW60, panels and swing door stack within opening, weather resistant low profile no channel saddle sill, panic hardware
Architect: TLCD Architecture

E. Gensler Morristown, Morristown NJ
HSW60, panels and swing door stack within opening, no floor track, open corner configuration
Architect: Gensler; Glazing Contractor: Access Architectural Glass & Aluminum

F. Vancouver Island Residence, Canada
HSW60, panels and swing door stack away from opening, weather resistant low profile no channel saddle sill, segmented curve configuration

G. Gunster Law Office, Miami FL
HSW60, panels and swing doors stack away from opening, STC-rated glass, no floor track configuration
Architect: ASD/SKY



A.

A. Lumen Restaurant, Detroit MI
 HSW60, panels stack within opening, weather resistant low profile no channel saddle sill, open corner configuration
 Architect: Touloukian Touloukian, Inc.
 Glazing Contractor: Edwards Glass Company



B. Santa Monica College Performing Arts Center, Santa Monica CA
 HSW60, panels stack away from opening, sawtooth angle design
 Architect: DLR Group
 Glazing Contractor: Perfection Glass Company



C. St. John The Baptist High School Library, West Islip NY
 HSW60, panels stack within opening, swing door attached to side jamb, no floor track configuration
 Architect: BBS Architects



B.



C.

Customized Assistance.

We're not just manufacturers. We're engaged design partners who will support you from early design development to construction development and beyond—turning your design ideas into 3D representations, and your visions into finished products.

After confirming the intent of your first drafts, our designated Conceptual Design Team can provide complimentary, customized conceptual drawings, 3D views, project-specific REVIT® files and animations. Contact us with your preliminary plans, and we'll work with you to find or create configuration and stacking concepts that fit your project's specific needs.

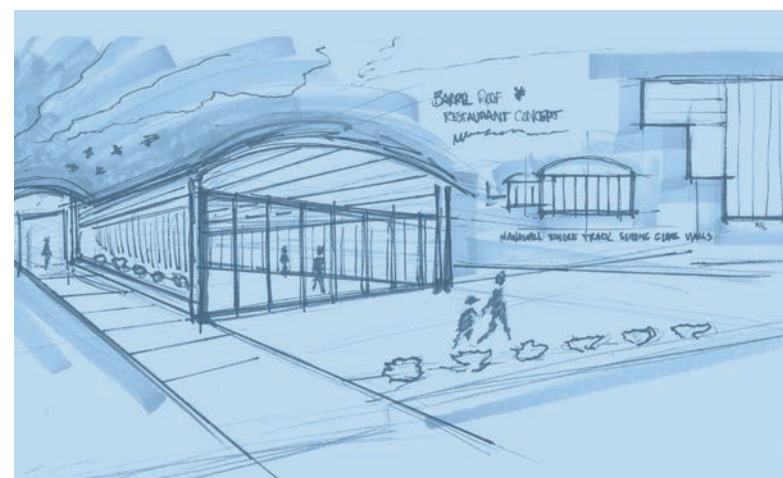

Each NanaWall system is custom-made to your specifications, based on your customer's preference and project requirements.



HSW60, panels stack away from opening, 12' panel heights, weather resistant low profile no channel saddle sill, open corner configuration



HSW60 System

ALUMINUM FRAMED SINGLE TRACK SLIDING SYSTEM.

- Thermally broken and weather-resistant.
- Individual panels can measure up to 4 feet (1220 mm) wide and 12 feet (3660 mm) tall.
- Swing doors may be placed almost anywhere in the opening.
- Has received statewide Florida approval with Product Approval number 17751.

To learn more about our HSW60 System, please visit nanawall.com/products/hsw60



HSW66 System

WOOD FRAMED SINGLE TRACK SLIDING SYSTEM.

- Framed with solid, cross-grained and triple-laminated wood; energy-efficient.
- Individual panels can measure up to 4 feet (1220 mm) wide and 10 feet (3050 mm) tall.
- Swing doors may be hinged to side jambs.
- Custom layouts with horizontal mullions are available.

To learn more about our HSW66 System, please visit nanawall.com/products/hsw66

Our sliding glass walls offer benefits that anyone can see. **And a few they can't.**

NanaWall helps architects design differently. From unlimited panels to design flexibility, it's easy to see the range of inspiring possibilities that our HSW systems' single track sliding glass walls make possible.

What's harder to spot are the number of ways in which our walls may be stacked away—making the most of your unused space, and permitting the creation of inviting, pure openings.

Our Conceptual Design Team can plan bays that accept panels inserted next to each other (sliding in at the same angle as the track), stacked against each other (90° angle to the track), or any angle in between—creating walls that add functionality, liberate space, and impress even when they're out of view.

STACKING CONCEPTS

Several basic stacking concepts are illustrated to the right. Animated versions of these graphics may be seen at nanawall.com/products/hsw60/options, and examples of custom stacking options are viewable at nanawall.com/custom-stacking-animations

- Though graphic examples show three to six panels, unlimited panel numbers are possible.
- Panels may stack to left or right, inside or outside, on one side, or on both sides.
- Stacking area may be wide or narrow (and with additional head track, can be located almost anywhere, near or far).
- Different panel heights in the same opening are possible (depending on layout).

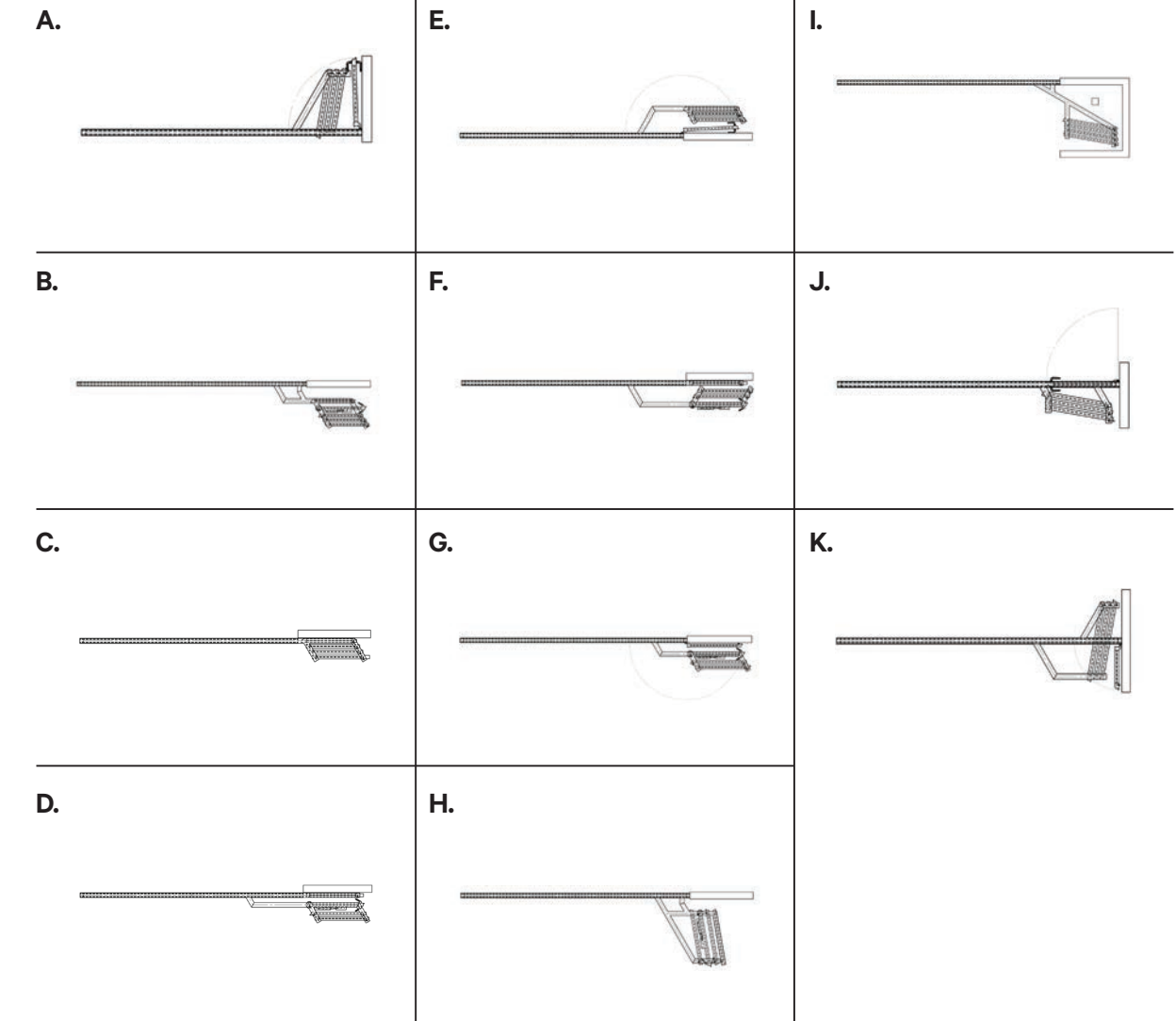

The standard stacking concepts shown here are offered on both HSW systems, although incorporated swing doors are only possible with our HSW60 System. Many other stacking configurations are available. Please submit your ideas and sketches for evaluation.

Sill and Head Track Options.

01 / LOW PROFILE SADDLE SILL

- Thermally broken for better insulation and energy efficiency
- Rated for water performance
- Partial or full insert available for ADA compliance
- Available in Clear or Bronze Anodized finishes

02 / SOCKET ONLY/NO FLOOR TRACK

- Creates seamless transitions for interiors or protected exteriors
- Concealed locking rods engage in adjustable floor sockets
- ADA-compliant
- Available in Clear Anodized finish

03 / SURFACE MOUNT INTERIOR SILL

- Used in interiors
- Sill rests above subfloor for easier installation
- Adjustable flanges and ADA-compliant, no channel in track
- Available in Clear or Bronze Anodized finishes

04 / FLUSH SILL

- For interiors or protected exteriors where weather performance is not needed
- Thermally broken for better insulation and energy efficiency
- ADA-compliant, no channel in track
- Available in Clear or Bronze Anodized finishes

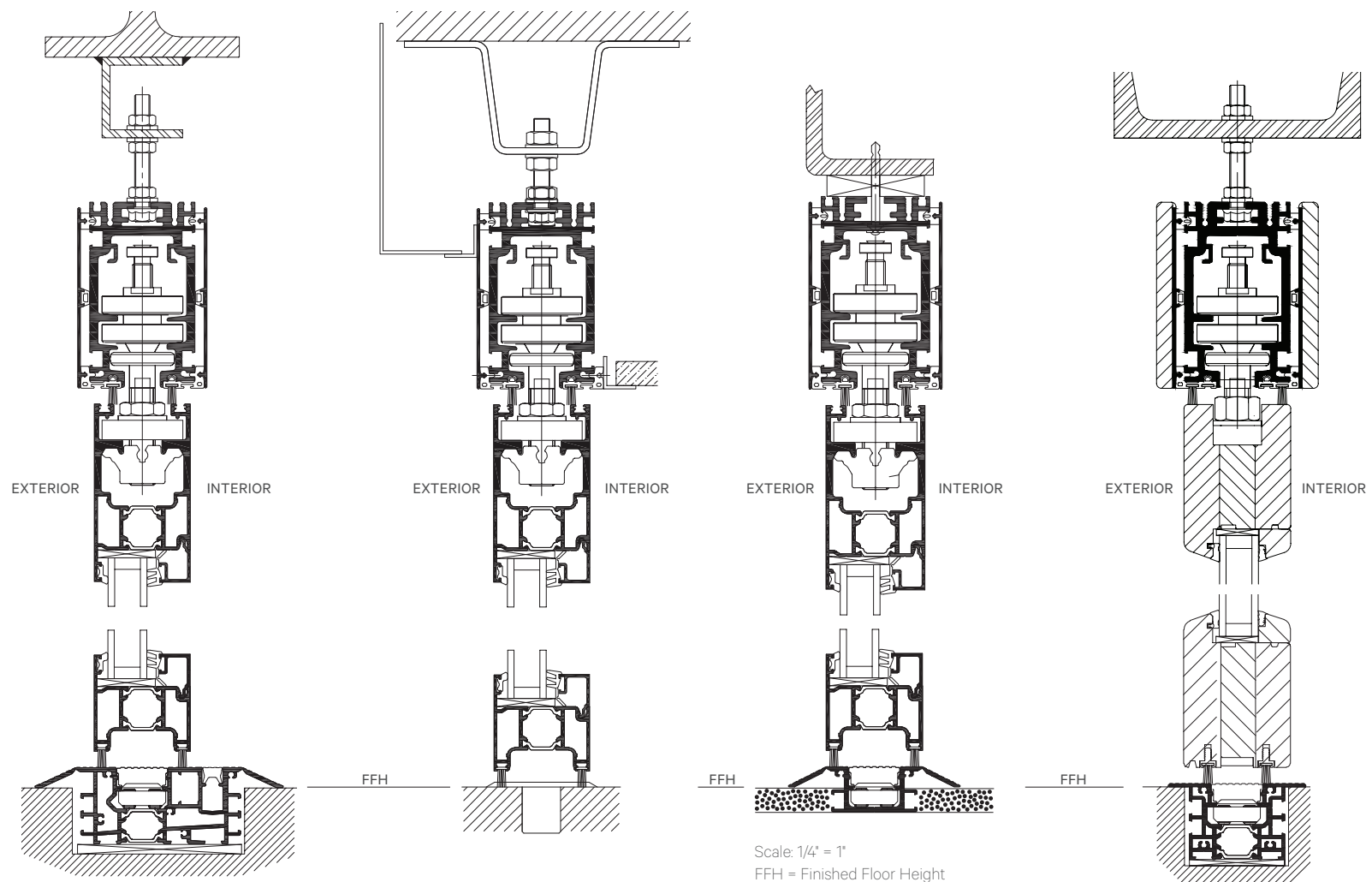

HSW60 Low Profile Saddle Sill

HSW60 Socket

HSW60 Surface Mount Interior Sill

HSW66 Flush Sill



A. Tight Weather Seal

Interlocking profiles and heavy-duty double siliconized EPDM gaskets create a tight weather seal that eliminates drafts and rattles.

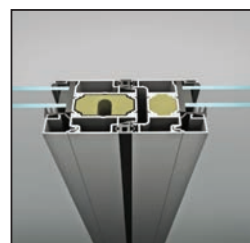

B. Thermal Barrier For Superior Energy Efficiency

Multichamber thermally-efficient aluminum profiles include a foam core, creating a 15/16" (24 mm) polyamide thermal barrier that adds strength, humidity control and acoustic attenuation. Sills minimize condensation.



C. Multipoint Locking Adds Solid Security

One turn of a handle activates concealed multipoint locking. Shooting up to engage the adjacent panel's hook receiver, and down to secure the panel to the floor track, the lockbolt creates a secure connection. Bottom shoot bolt has full 1" (25 mm) throw.



D. Intelligent Roller and Track Ensure Trouble-Free Operation

Unique rollers and guide technology allows easy single-handed movement of panels into stacking bays. Self-lubricated, oil-infused bronze rollers with ball bearings and stainless steel axles support quiet operation and are engineered for longevity.

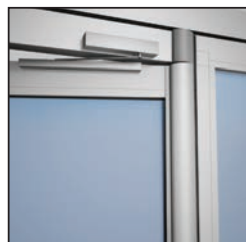

E. Swing Doors Slide Away

If desired, the HSW60 System allows every sliding panel to include an incorporated single-action swing door with an overhead door closer.

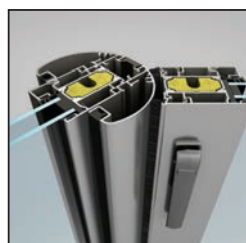

F. Rounded Door Panels Prevent Pinching

Rounded profiles on swing doors protect against pinching during opening and closing.



G. Subtle Locking and Accessories Create Clean Lines

Swing door conversion locking rods are concealed by an innovative profile, and all accessories are integrated into the system, creating a smooth appearance.



H. Handsome Hardware Lends Durability

Hardy, stainless steel lever handles and pull handles (available in a range of shapes and finishes) ensure easy operation of swing doors. If desired, panic hardware is available.



HSW60, panels and swing doors stack away from opening, weather resistant low profile no channel saddle sill, open corner configuration

HSW60 Performance

AIR INFILTRATION

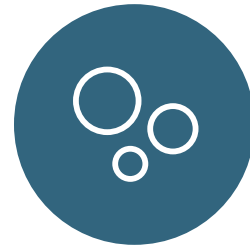

HSW60:
Air Infiltration as low as:
@1.56 psf: .12
@1.56 psf: .30
(with incorporated swing door)
@6.24 psf: .30

WATER PENETRATION



HSW60:
No uncontrolled water entry with Low Profile Saddle Sill at:
@2.92 psf (140 Pa)
(with weepholes from middle channel)
@6 psf (290 Pa)
(with weepholes from inner channel)

STRUCTURAL LOAD DEFLECTION



HSW60:
With panel height of 9'5" (2870 mm)
Positive @45 psf
Negative @45 psf

FORCED ENTRY RESISTANCE



HSW60:
ASTM F842 Pass

ACOUSTICAL PERFORMANCE



HSW60:
Acoustics with STC 45 glass:
System STC of 43 with head track recessed
System STC of 41 with head track exposed

Test results vary per system.

Our HSW systems' single track sliding glass walls have been tested for air, water, structural loads, wind loads, forced entry, thermal resistance and acoustical performance. To review our performance results, please visit nanawall.com/products/hsw60/performance and nanawall.com/products/hsw66/performance

Finish Options

STANDARD 50 FINISHES FOR ALUMINUM FRAMED HSW60 SYSTEM

The 50 standard powder coating finishes shown are only some of the over 200 colors we offer (in RAL GLOSS powder-coated and RAL MATTE powder-coated) for our aluminum framed system. Custom color-matching is available upon request. (For accurate color swatch examples, please request our Powder Coating Finish Options brochure.)



HARDWARE OPTIONS

Standard locking hardware is compatible with a range of commercially available handle sets and escutcheon plates, matching any design style.



To see additional hardware and accessory options, please visit nanawall.com/products/hsw60/handles (for our HSW60 System) or nanawall.com/products/hsw66/handles (for our HSW66 System).

FINISH OPTIONS FOR WOOD FRAMED HSW66 SYSTEM

Standard woods include Sapeli Mahogany, Pine, Spruce, Meranti and Western Hemlock. Oak, Douglas Fir and other specialty woods are available upon request. Please consult NanaWall for additional costs. (For accurate wood representation, please request our Wood & Finish Options brochure.)

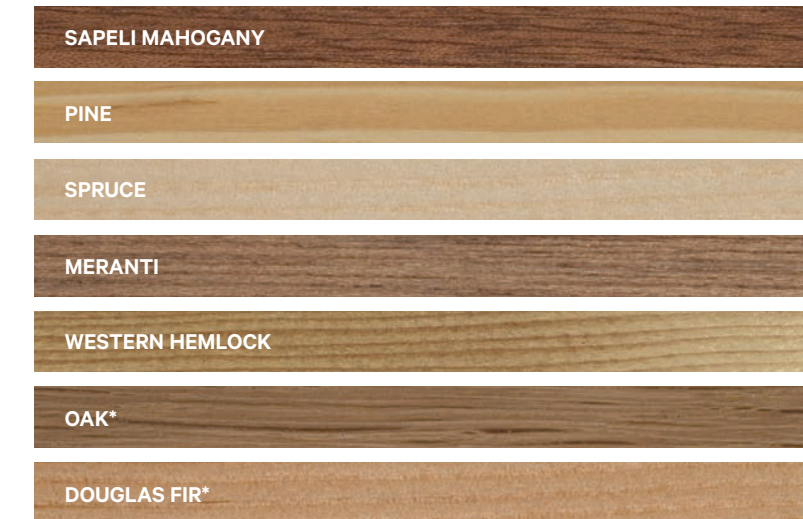

*Available with upcharge.

GLAZING AREA OPTIONS

Glazing options include: insulated; low-E; argon-filled, triple-insulated low-E; bird protection glass; turtle glass; heat mirror; impact; laminated; and other specialty glass.

We don't just inspire the extraordinary.
We give it shape.



On this spread:

HSW66, panels stack away from opening, solid wood panel profiles, weather resistant low profile no channel saddle sill, four openings in total including Kitchen Transition window/door configuration



On back cover:

HSW60, panels and swing doors stack away from opening, weather resistant low profile no channel saddle sill, segmented curve configuration



Folding Glass Walls



cero® by NanaWall



Frameless Glass Walls

Frequently imitated. **Never equaled.**

NanaWall has reinvented the category of opening glass wall systems. Throughout our 30-plus-year history, we have earned the trust of architects, builders, design professionals and homeowners. As a solutions provider, we reimagine the ways in which buildings, people and the elements interact. By combining precision engineering and outstanding design options across more than 25 unique systems, we advance design possibilities beyond the conventional.

Visit nanawall.com to learn more about all our premium opening glass walls.

NanaWall®

Nana Wall Systems, Inc.
100 Meadowcreek Drive #250
Corte Madera, CA 94925

800 873 5673
415 383 3148
Fax 415 383 0312

info@nanawall.com
nanawall.com

© 2019 NANA WALL SYSTEMS, INC. Nana Wall Systems reserves the right to change specifications without notice. Testing results vary per system. See the NanaWall Architectural Binder for actual test data. NanaWall, the NanaWall logo and Boundaries Unbound are trademarks of Nana Wall Systems, Inc. All other trademarks are the property of their respective owners. r2-0119

SOLARLUX®
technology

Boundaries **Unbound.™**