

Suggested Typical Installation Inward Opening Details
NW Acoustical 645

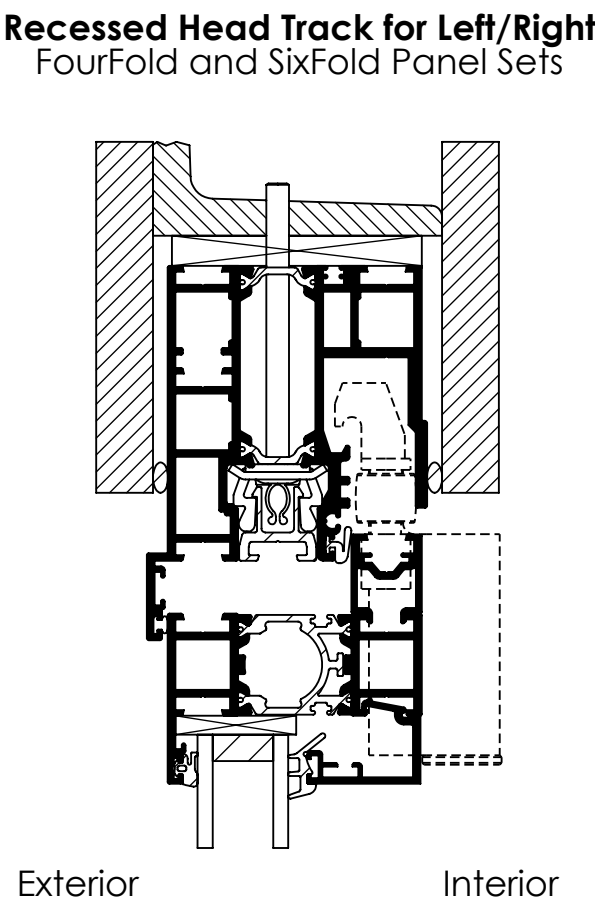

Surface Mounted Flush Sill
(To prevent sill deflection, shims between the anchor points should be installed and any cavities between the shims should be filled with non expanding grout. If filling with grout is not possible, continuous shims should be placed along the entire length of the sill to provide continuous solid support and level condition.)

Flush Sill

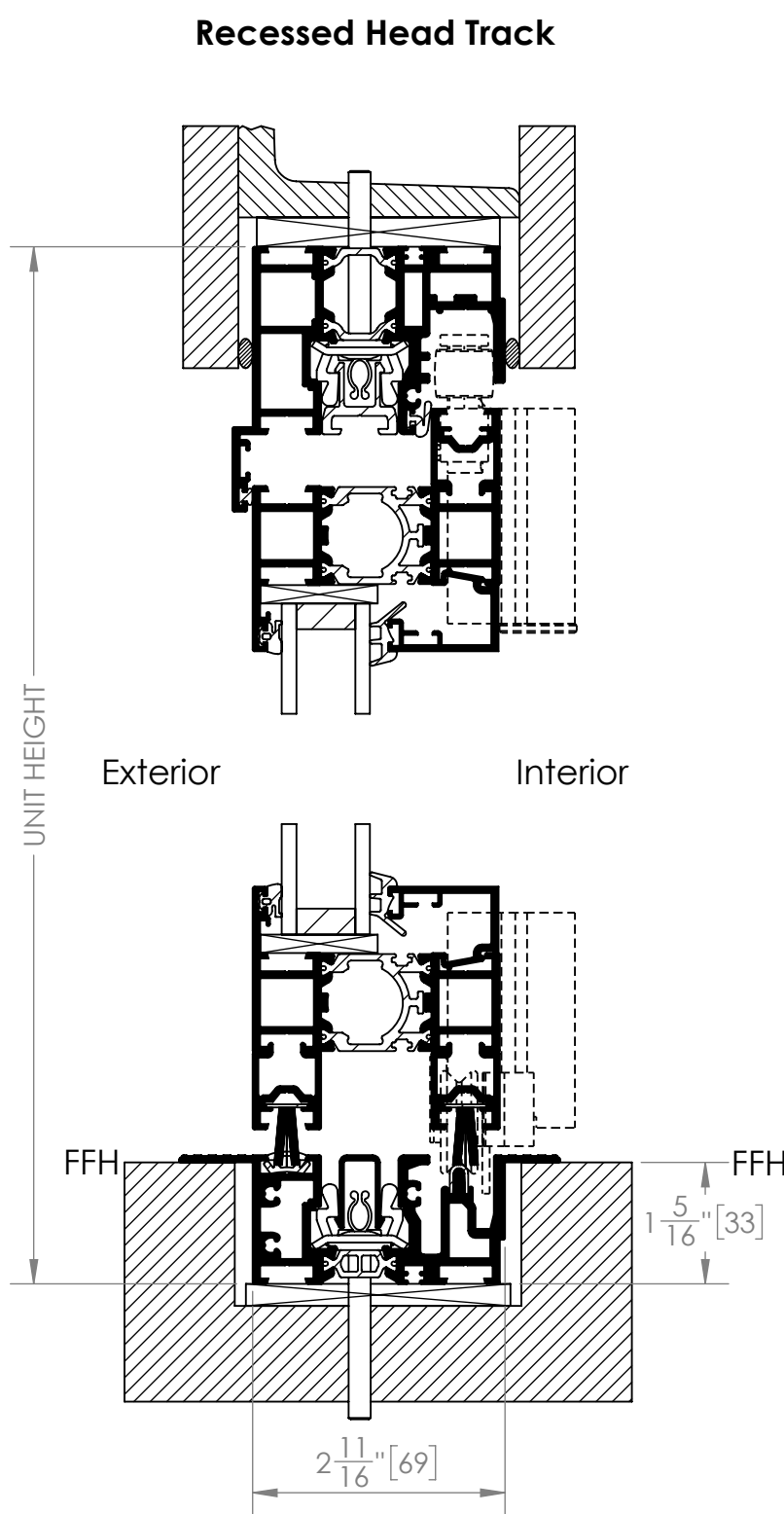
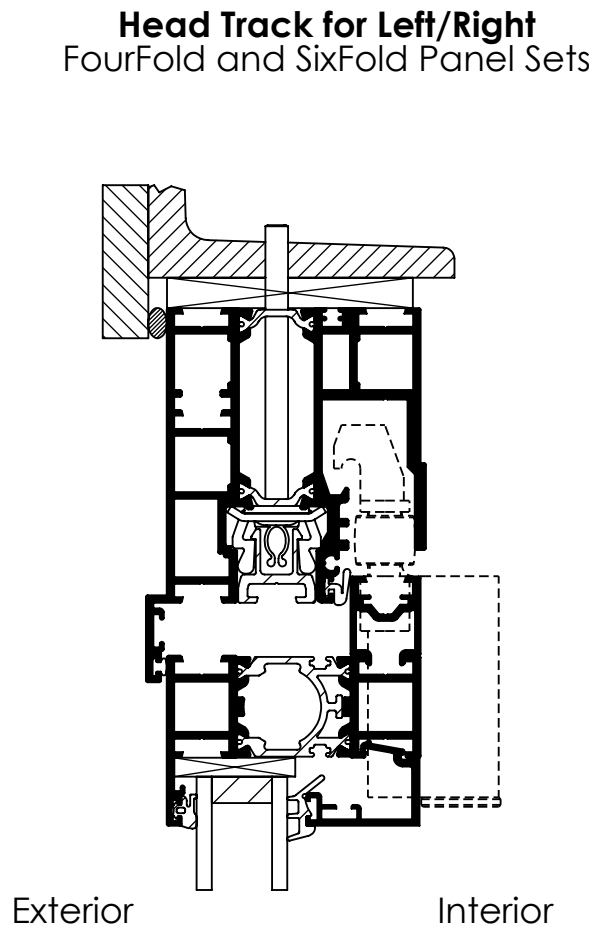
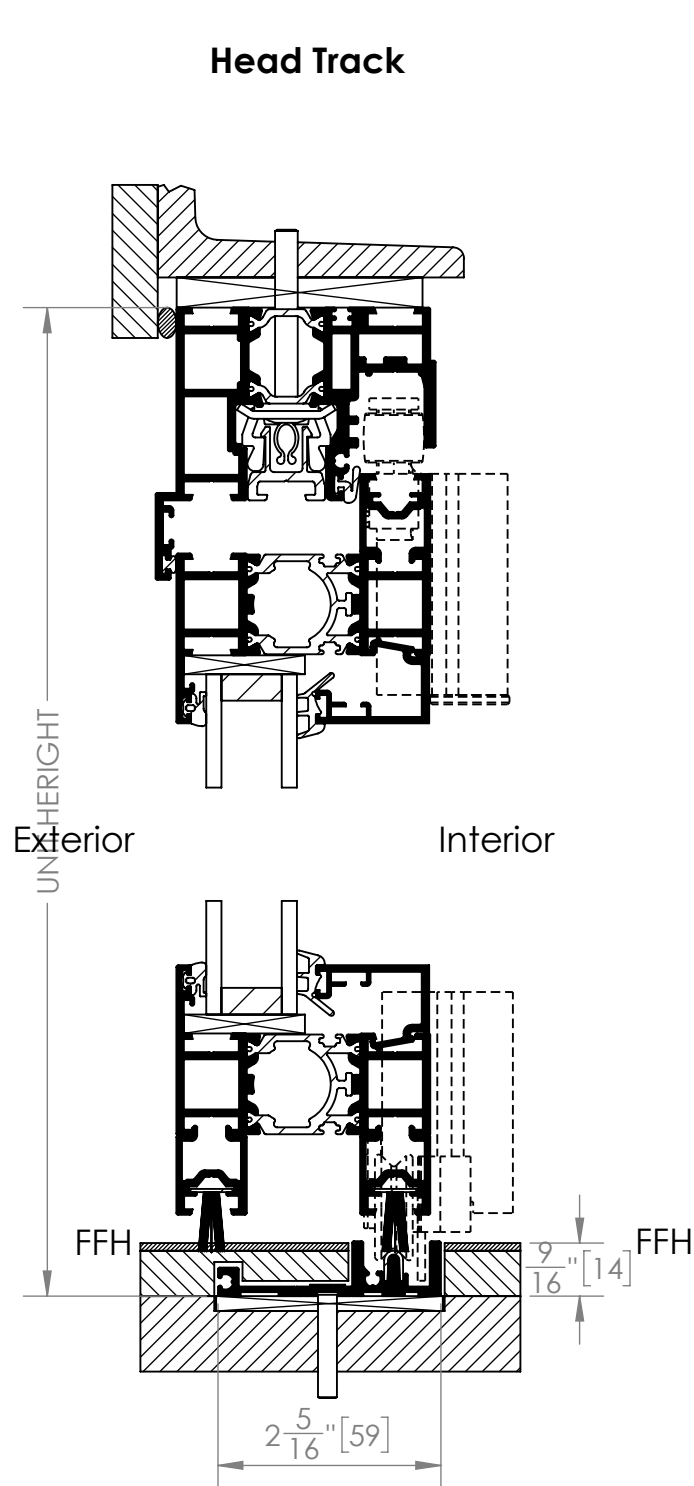
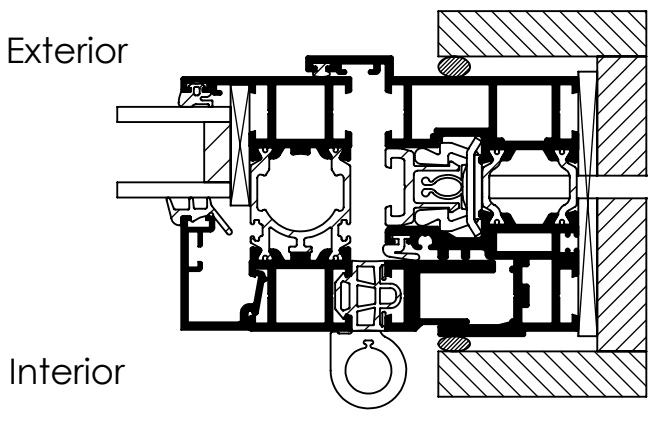
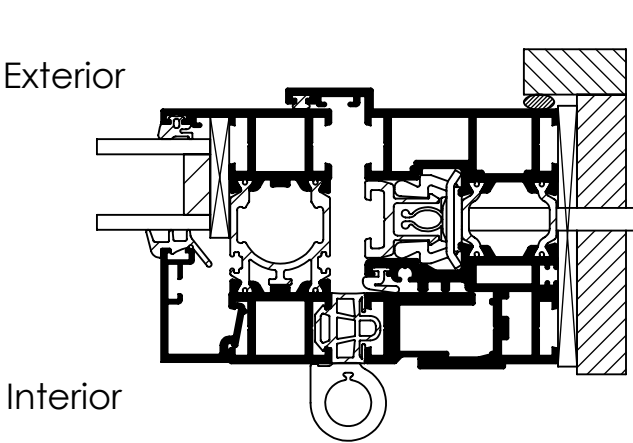

SPECIFICATIONS AND DETAILS SUBJECT
TO CHANGE WITHOUT NOTICE
©2025 NanaWall Systems, Inc.
www.nanawall.com

For more information about preparing the rough opening, installation and operation of this folding system, please look at the installation and Owner's Manual for the Generation 4 Folding Glass Walls.